

Baertec

www.baertec.com

PVC AND PROFILE ALUMINIUM MACHINES





PVC and ALUMINIUM

METAL
PROCESSING

Baertec

ABOUT US

In 1973

Baertec Machinery took its place in Bursa Industry by producing **Aluminium and Pvc & Metal Processing Machinery**.

In 1973 Baertec Machinery took their place in Bursa industrial market by production of Aluminium and PVC & Metal processing machinery. In 1989 Baertec Machinery added PVC and Aluminium processing machinery to their production line at their 500 m2 facility in Bursa Besevler and this took Baertec ahead of many other existing manufacturers. By the increase of demand in market, company expanded with manufacturing more and different types of products and moved to their new facility at Nilufer Organize Sanayi Bolgesi in 2002 to provide service in a 3000 m2 production area. In 2006 the company started production of band saw machines and this led them into metal industry.

In local market, Baertec Machinery proved their in production of PVC and Aluminium processing machines, continously developed their manufacturing capacity and started exporting the products to 30 different countries.

Supplying products with the highest quality has become our prior principle and it is appreciated by our valued clients worldwide. To achive this quality, we have maximized our research and development studies and rised up our investments in it. As a result of this R&D process, we added vertical and horizontal CNC operated machines to our production profile.

All Baertec products meet CE standards and are ready to be delivered to our clients in any country. Baertec has ISO 9001 quality assurance certificate and practices the quality standard in all departments and manufacturing operation through regular quality controls.

Baertec



SAWS

- 6 **DKP400** / Portable Manual Mitre Saw 400 mm
- 7 **2DK400** / Manual Mitre Saw - 400 mm Saw Blade
- 8 **2AC400** / Automatic Upcut Mitre Saw - 400 mm Saw Blade
- 9 **2MAC420** Manual Up-Cut Mitre 420 mm Saw Blade
- 10 **2MAC450** Manual Up Cut Mitre 450 mm Saw Blade
- 11 **2AC 500** / Automatic Up Cut Mitre Saw 500 mm
- 12 **2AC550** / Automatic Up Cut Mitre Saw 550 mm
- 13 **2CK** / Automatic Glazing Bead Saw
- 14 **2AV** / Automatic V-Cutting Saw
- 15 **2COALC420** / Double Head Mitre Saw 420 mm
- 16 **2COALC420 - S** / Double Head Mitre Saw 450 mm
- 17 **2COALC450** / Double Head Mitre Saw 450 mm
- 18 **2COALC450-S** / Double Head Mitre Saw 450 mm (Special)
- 19 **2COALC500** / Double Head Mitre Saw 500 mm
- 20 **2COALC500 - S** / Double Head Mitre Saw 500 mm (Special)



Description

- 3 HP Arçelik (TEE) motor. 380 V. (optional: 220 V)
- Overload protection switch
- 2 user fr. clamps (at 1 and 2). Can be tilted to both sides, tighten with single move
- 2 pneumatic clamps (at 3 and 4)
- Even surface preventing insertion of saw dust
- User friendly ergonomic handle
- Gas spring
- Shock absorbing stopping system
- Saw blade guard in accordance with CE
- Wedged fork & turntable system preventing adjustment of set square



Optional

- Saw blades
- Cooling system



Technical specifications

- Power supply: 230 - 400 V, 3ph, 50-60 Hz
- Power output: 1,5 kW
- Spindle speed: 2,800 r.p.m.
- Air pressure: 6-8 bar
- Air consumption: 5 l/min.
- Machine height: 650 mm
- Machine length: 640 mm
- Machine width: 580 mm
- Machine weight: 70 kg

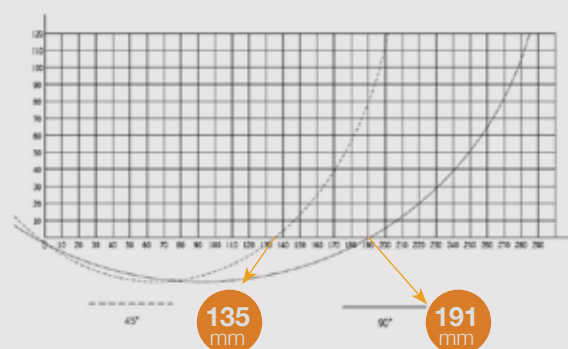

2 DK 400

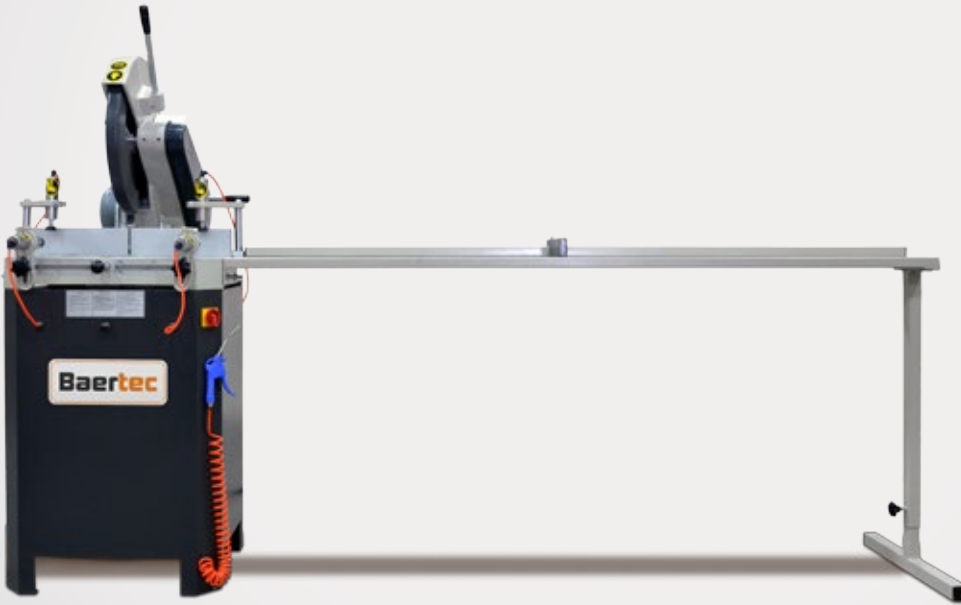

Description

- PVC profiles cutting with 400 mm. saw blade diameter.
- Stable, ground, continuous support table with turn table on precision bearings
- Wear-resistant and quiet multi-V belt drive
- Manual saw feed
- Equipped with saw blade as standard



Optional

- Pneumatic material clamping
- Quick-acting clamping device
- Roller conveyors
- Saw blades
- Cooling system



Technical specifications

- Pivoting range from 0° – 45°, continuously adjustable to the left and to the right
- Positive location points at 15°, 30°, and 45°
- For cutting range, see cutting diagram
- Saw blade diameter 400 mm
- Saw blade speed 2,800 rpm
- Power supply 230 / 400 V, 3~, 50 Hz
- Power output 1.5 kW
- Length 760 mm,
- Depth 880 mm,
- Height 815 mm,
- Weight 110 kg

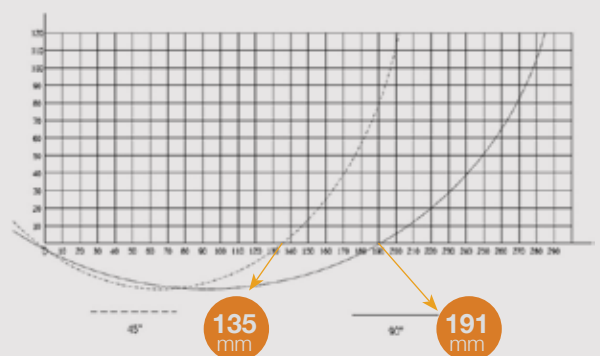



Description

- For Aluminum and PVC profiles cutting.
- Double-hand system
- Pneumatic sawing feed from below with 400 mm. saw blade diameter.
- The saw blade feed speed can be adjusted.- Wide angle range from special location points at 45°, 90°.
- Vertical pneumatic clamps ensure optimum profile fixing.



Optional

- Extraction system
- Length stop and measuring systems
- Roller conveyors
- Saw blades
- Cooling system



Technical specifications

- Power supply: 400 V, 3ph, 50-60 Hz
- Power output: 1.5 kW
- Spindle speed: 2,800 r.p.m.
- Air pressure: 6-8 bar
- Air consumption: 15 l/min.
- Machine height: 1,280 mm
- Machine length: 640 mm
- Machine width: 640 mm
- Machine weight: 132 kg

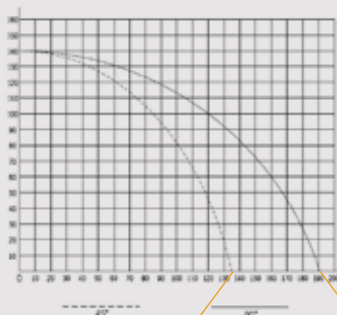

2 MAC 420



Description

- Free cutting possible via graduated scale
- 2 x vertical clamps (manual)
- Simple change of the saw
- Possibility to raise and lower the saw manual
- High quality blade included (420 mm)
- Profile support gadget
- Air gun (optional)
- Spray mist blade lubricator (optional)
- Pneumatic clamps (optional)
- CE Certified (optional)



Technical specifications

- Power supply: 400 V, 3ph, 50-60 Hz / 230V
- Power output: 2,2 kW
- Spindle speed: 3,000 r.p.m
- Machine height: 1,400 mm
- Machine length: 640 mm
- Machine width: 950 mm
- Machine weight: 142 kg



Description

- Free cutting possible via graduated scale
- 2 x vertical clamps (manual)
- Simple change of the saw
- Possibility to raise and lower the saw manual
- High quality blade included (450 mm)
- Profile support gadget
- Air gun (optional)
- Spray mist blade lubricator (optional)
- Pneumatic clamps (optional)
- CE Certified (optional)



Technical specifications

- Power supply: 400 V, 3ph, 50-60 Hz / 230V
- Power output: 2,2 kW
- Spindle speed: 3,000 r.p.m
- Machine height: 1,400 mm
- Machine length: 640 mm
- Machine width: 950 mm
- Machine weight: 142 kg

2 AC 500



11



Description

- For Aluminum and PVC profiles cutting.
- Double-hand system
- Pneumatic sawing feed from below with 500 mm. saw blade diameter.
- The saw blade feed speed can be adjusted.- Wide angle range from 22,5° to 112,5° with special location points at 45°, 90° and 135°.
- Vertical pneumatic clamps ensure optimum profile fixing.



Optional

- Extraction system
- Length stop and measuring systems
- Roller conveyors
- Saw blades
- Cooling system
- Hydropneumatic system



Technical specifications

- Power supply: 400 V, 3ph, 50-60 Hz
- Power output: 3 kW
- Spindle speed: 2,800 r.p.m.
- Air pressure: 6-8 bar
- Air consumption: 15 l/min.
- Machine height: 1,480 mm
- Machine length: 860 mm
- Machine width: 840 mm
- Machine weight: 172 kg

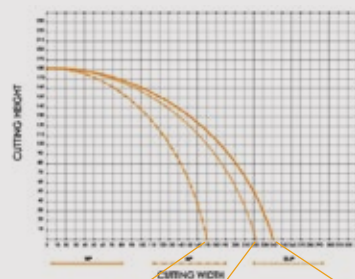
170
mm222
mm240
mm

Baertec



Description

- For Aluminum and PVC profiles cutting.
- Double-hand system
- Pneumatic sawing feed from below with 550 mm. saw blade diameter.
- The saw blade feed speed can be adjusted.- Wide angle range from 22,5° to 112,5° with special location points at 45°, 90° and 135°.
- Vertical pneumatic clamps ensure optimum profile fixing.



Optional

- Extraction system
- Length stop and measuring systems
- Roller conveyors
- Saw blades
- Cooling system
- Hydropneumatic system



Technical specifications

- Power supply: 400 V, 3ph, 50-60 Hz
- Power output: 3 kW
- Spindle speed: 2,800 r.p.m.
- Air pressure: 6-8 bar
- Air consumption: 15 l/min.
- Machine height: 1,480 mm
- Machine length: 860 mm
- Machine width: 840 mm
- Machine weight: 182 kg

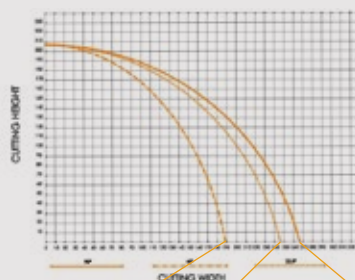

189 mm

248 mm

267 mm

2 CK



13



Description

- 4 special saw blades positioned at 45° for simultaneous undercutting of the glazing bead profiles.
- Double-hand system
- By means of special counterblocks two glazing bead profiles can be cut at the same time.
- Automatic operation with adjustable feed speed.
- Counterblocks can be changed easily.
- Two vertical pneumatic clamps enable optimum work piece fixation



Technical specifications

- Power supply: 400 V, 3ph, 50-60 Hz
- Total power output: 1,5 kW
- Power output of each motor: 0.75 kW x 2
- Spindle speed: 2,800 r.p.m.
- Saw blade diameter: Ø 200 mm. x 2; Ø 100 mm. x 2
- Max. cutting length: 3,000 mm.
- Min. cutting length: 230 mm.
- Air pressure: 6-8 bar
- Air consumption: 70 l/min



Description

- Two 45° angled saw blades with 200 mm. diameter, V-cuts PVC profiles for V-welding.
- The cutting depth can be set easily.
- The adjustable saw blade feed enable fast and precise cutting with rapid return.
- Horizontal pneumatic clamps are positioned opposite of the movement direction to ensure optimum profile fixing.



Technical specifications

- Power supply: 400 V, 3ph, 50-60 Hz
- Total power output: 1,5 kW (0.75 kW x 2)
- Spindle speed: 2,800 r.p.m
- Air pressure: 6-8 bar
- Air consumption: 60 l/min.
- Machine height: 1,110 mm
- Machine length: 450 mm (+2,000 mm. left, + 2,000 mm. right conveyor)
- Machine width: 1,110 mm
- Machine weight: 170 kg

2 CO ALC 420

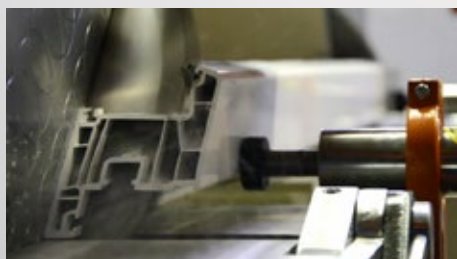

Description

- For PVC and Aluminum profiles cutting.
- Double-hand system
- Ultimate cutting quality. Automatic tilt movement of the saw heads to 45° and 90°. Angles between 45° and 90° can be adjusted manually and fixed easily.
- The 420 mm. saw blade diameter enables to cut wide profiles as well as two 60 mm. profiles at the same time.
- The saw blade feed speed can be adjusted.
- Fixed profile support conveyor on the mobile right provides work piece stability



Optional

- Barcode printer.
- Cooling system to cut aluminum profiles.
- Hydro-pneumatic system for aluminum profiles.



Technical specifications

- Power supply: 400 V, 3ph, 50-60 Hz
- Power output of each motor: 1.5 kW
- Spindle speed: 2,800 r.p.m.
- Max. profile Width: 120 mm
- Max. cutting Length: 3,450 mm
- Min. cutting Length: 450 mm
- Air pressure: 6-8 bar
- Air consumption: 45 lt/min. (120 lt/min. cooling system)
- Machine height: 1,200 mm
- Machine length: 3,900 mm
- Machine width: 1,300 mm
- Machine weight: 680 kg

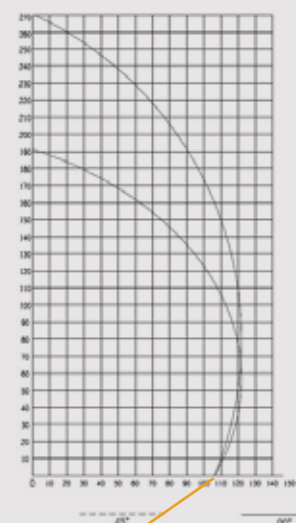

105 mm



Description

- For PVC and Aluminum profiles cutting.
- Double-hand system
- Ultimate cutting quality. Automatic tilt movement of the saw heads to 45° and 90°. Angles between 45° and 90° can be adjusted manually and fixed easily.
- The 420 mm. saw blade diameter enables to cut wide profiles as well as two 60 mm. profiles at the same time.
- The saw blade feed speed can be adjusted.
- Fixed profile support conveyor on the mobile right provides work piece stability



Optional

- Barcode printer.
- Cooling system to cut aluminum profiles.
- Hydro-pneumatic system for aluminum profiles.



Technical specifications

- Power supply: 400 V, 3ph, 50-60 Hz
- Power output of each motor: 1.5 kW
- Spindle speed: 2,800 r.p.m.
- Max. profile Width: 120 mm
- Max. cutting Length: 4,350 mm
- Min. cutting Length: 450 mm
- Air pressure: 6-8 bar
- Air consumption: 45 lt/min. (120 lt/min. cooling system)
- Machine height: 1,200 mm
- Machine length: 3,900 mm
- Machine width: 1,300 mm
- Machine weight: 850 kg

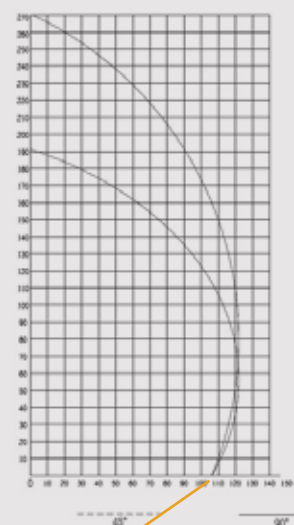

105 mm

2 CO ALC 450

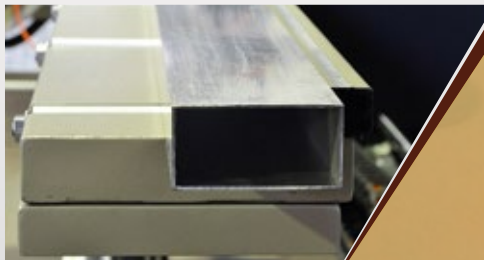
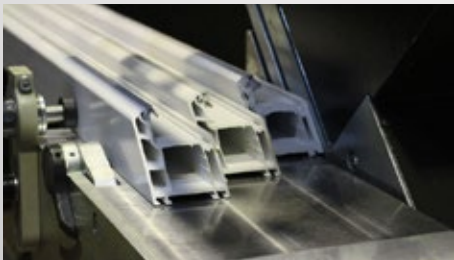

Description

- For PVC and Aluminum profiles cutting.
- Double-hand system
- Ultimate cutting quality. Automatic tilt movement of the saw heads to 45° and 90°. Angles between 45° and 90° can be adjusted manually and fixed easily.
- The 450 mm. saw blade diameter enables to cut wide profiles as well as two 70 mm. profiles at the same time.
- The saw blade feed speed can be adjusted.
- Fixed profile support conveyor on the mobile right provides work piece stability
- Right - Left move Touch Screen control Automatic



Technical specifications

- Power supply: 400 V, 3ph, 50-60 Hz
- Power output of each motor: 2.2 kW
- Spindle speed: 2,800 r.p.m.
- Max. profile Width: 148 mm
- Max. cutting Length: 3,450 mm
- Min. cutting Length: 450 mm
- Air pressure: 6-8 bar
- Air consumption: 45 lt/min. (120 lt/min. cooling system)
- Machine height: 1,200 mm
- Machine length: 3,900 mm
- Machine width: 1,300 mm
- Machine weight: 650 kg

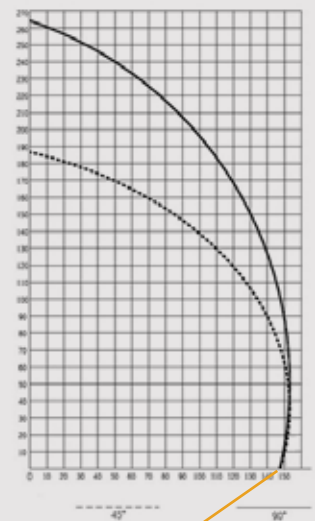

148 mm



Optional

- Barcode printer.
- Cooling system to cut aluminum profiles.
- Hydro-pneumatic system for aluminum profiles.

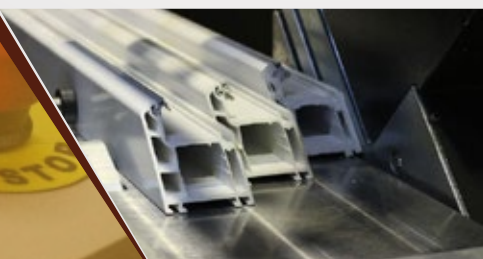

Description

- For PVC and Aluminum profiles cutting.
- Max.Cutting Length : 5000 mm
- Double-hand system
- Ultimate cutting quality.Automatic tilt movement of the saw heads to 45° and 90°. Angles between 45° and 90° can be adjusted manually and fixed easily.
- The 450 mm. saw blade diameter enables to cut wide profiles as well as two 70 mm.profiles at the same time.
- The saw blade feed speed can be adjusted.
- Fixed profile support conveyor on the mobile right provides work piece stability
- Right - Left move Touch Screen control Automatic



Optional

- Barcode printer.
- Cooling system to cut aluminum profiles.
- Hydro-pneumatic system for aluminum profiles.



Technical specifications

- Power supply: 400 V, 3ph, 50-60 Hz
- Power output of each motor: 2.2 kW
- Spindle speed: 2,800 r.p.m.
- Max. profile Width: 148 mm
- Max. cutting Length: 5,000 mm
- Min. cutting Length: 450 mm
- Air pressure: 6-8 bar
- Air consumption: 45 lt/min. (120 lt/ min. cooling system)
- Machine height: 1,300 mm
- Machine length: 5,550 mm
- Machine width: 1,350 mm
- Machine weight: 770 kg

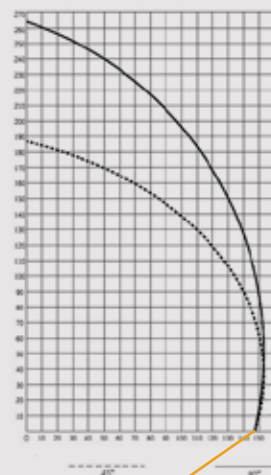

148 mm

2 CO ALC 500

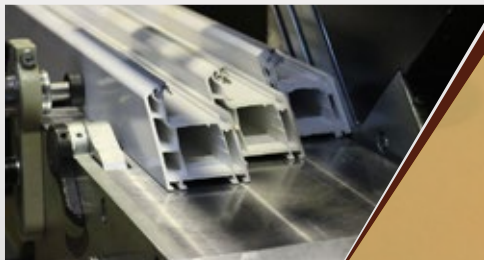

Description

- For PVC and Aluminum profiles cutting.
- Double-hand system.
- Ultimate cutting quality. Automatic tilt movement of the saw heads to 45° and 90°. Angles between 45° and 90° can be adjusted manually and fixed easily.
- The 500 mm. saw blade diameter enables to cut wide profiles as well as two 80 mm. profiles at the same time.
- The saw blade feed speed can be adjusted.
- Fixed profile support conveyor on the mobile right provides work piece stability
- Right - Left move Touch Screen control Automatic



Optional

- Barcode printer.
- Cooling system to cut aluminum profiles.
- Hydro-pneumatic system for aluminum profiles.



Technical specifications

- Power supply: 400 V, 3ph, 50-60 Hz
- Power output of each motor: 2.2 kW
- Spindle speed: 2,800 r.p.m.
- Max. profile Width: 173 mm
- Max. cutting Length: 3,450 mm
- Min. cutting Length: 470 mm
- Air pressure: 6-8 bar
- Air consumption: 45 lt/min. (120 lt/min. cooling system)
- Machine height: 1,300 mm
- Machine length: 4,000 mm
- Machine width: 1,400 mm
- Machine weight: 750 kg

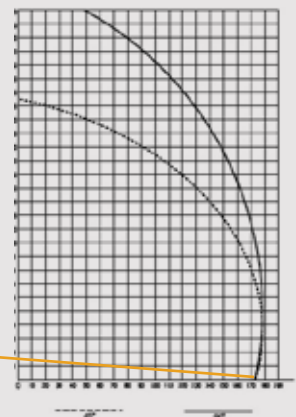

173 mm

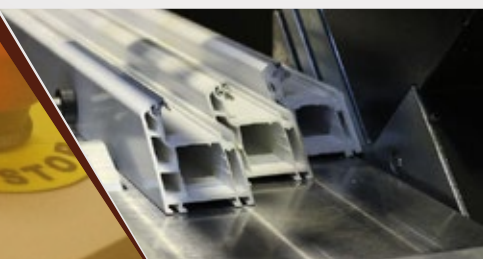

Description

- For PVC and Aluminum profiles cutting.
- Max.Cutting Length : 5000 mm
- Double-hand system
- Ultimate cutting quality.Automatic tilt movement of the saw heads to 45° and 90°. Angles between 45° and 90° can be adjusted manually and fixed easily.
- The 500 mm. saw blade diameter enables to cut wide profiles as well as two 80 mm.profiles at the same time.
- The saw blade feed speed can be adjusted.
- Fixed profile support conveyor on the mobile right provides work piece stability
- Right - Left move Touch Screen control Automatic



Optional

- Barcode printer.
- Cooling system to cut aluminum profiles.
- Hydro-pneumatic system for aluminum profiles.



Technical specifications

- Power supply: 400 V, 3ph, 50-60 Hz
- Power output of each motor: 2.2 kW
- Spindle speed: 2,800 r.p.m.
- Max. profile Width: 173 mm
- Max. cutting Length: 5,000 mm
- Min. cutting Length: 470 mm
- Air pressure: 6-8 bar
- Air consumption: 45 lt/min. (120 lt/min. cooling system)
- Machine height: 1,300 mm
- Machine length: 6,000 mm
- Machine width: 1,400 mm
- Machine weight: 790 kg

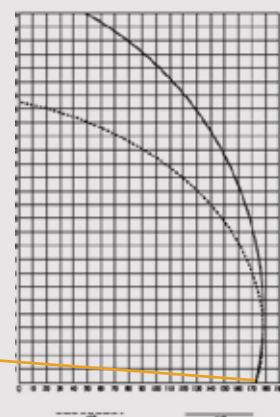



WELDING MACHINES

- ИНСТРУКЦИЯ**
- Перед запуском станка внимательно прочтите инструкцию по эксплуатации.
 - Станок должен эксплуатироваться с применением трехфазовой электрической сети с заземлением типа ТБ А под напряжением 220 В.
 - Начальное давление должно быть 7 бар, а давление на оставке 4 бар.
 - Перед запуском проконтролируйте показатели работы и времени: режим плавления 15-25 сек., температура плавления 200°С - 250°С, время охлаждения 10-20 сек.
 - Периодически проконтролируйте уровень масла в кондиционере.
 - в случае нехватки добавить масло № 10.
 - Периодически проконтролируйте уровень воды в кондиционере. в случае нехватки добавить в кондиционер.
 - Провести периодический уход станка.

- 24 **2TM** / PVC Single Corner Welding Machine
- 25 **2OTM** / PVC Single Corner Welding Machine 0,2 mm
- 26 **2OTM-S** / PVC Single Corner Welding Machine 0,2 mm
- 27 **2CM** / Double Head Welding Machine (Touch Screen)
- 28 **2NCM | 2NCM-S** Double Head Welding Machine 0,2 mm (Touch Screen)
- 29 **V Type** Automatic Welding Machine
- 30 **4NCM** / CNC 4 Head Welding Machine



Description

- Strongly welds PVC profiles at variable angles between 45° - 180°
- Melting and welding time are digitally adjusted.
- All operations are controlled by the digital touchscreen display.
- Long lasting heating plates distribute heat homogenously.
- Ability to clean the heater plates easily.
- Long lasting Teflon usage and easy change by special Teflon system.
- Practical welding fixture changing system.



Technical specifications

- Power supply: 230 V, 50-60 Hz
- Power output: 1.5 kW
- Max. profile width: 120 mm (for 90° welding)
- Max. profile height: 120 mm
- Min. profile height: 38 mm
- Air pressure: 6-8 bar
- Air consumption: 28 l/min.

2 OTM



25



Description

- Strongly welds PVC profiles at variable angles between 45° - 180°
- Welds both colored and white profiles with 0,2 mm. welding seam restriction.
- Melting and welding time are digitally adjusted.
- All operations are controlled by the digital touchscreen display.
- Long lasting heating plates distribute heat homogenously.
- Ability to clean the heater plates easily.
- Long lasting Teflon usage and easy change by special Teflon system.
- Practical welding fixture changing system.



Technical specifications

- Power supply: 230 V, 50-60 Hz
- Power output: 1.5 kW
- Max. profile width: 130 mm (for 90° welding)
- Max. profile height: 160 mm
- Min. profile height: 38 mm
- Air pressure: 6-8 bar
- Air consumption: 28 l/min



Description

- Strongly welds PVC profiles at variable angles between 45° - 180°
- Press First starting at 2 bar then up to 6 Bar
- Welds both colored and white profiles with 0,2 mm. welding seam restriction.
- Melting and welding time are digitally adjusted.
- All operations are controlled by the digital touchscreen display.
- Long lasting heating plates distribute heat homogenously.
- Ability to clean the heater plates easily.
- Long lasting Teflon usage and easy change by special Teflon system.
- Practical welding fixture changing system.



Technical specifications

- Power supply: 230 V, 50-60 Hz
- Power output: 1.5 kW
- Max. profile width: 150 mm (for 90° welding)
- Max. profile height: 180 mm
- Min. profile height: 38 mm
- Air pressure: 6-8 bar
- Air consumption: 28 l/min/

Double Head Welding Machine (Touch Screen)

WELDING
MACHINES

2 CM



27



Description

- Strongly welds two corners of PVC profiles with single operation.
- PLC control system
- Double-hand system
- Fixed left head allows welding at variable angles between 30° - 180°.
- Manually movable right head welds 90°.
- Movable head is moved to the desired position manually and fixed by pneumatic brakes.
- All operations are controlled by the digital touchscreen display.
- Long lasting heating plates distribute heat homogenously.
- Ability to clean the heater plates easily.
- Long lasting Teflon usage and easy change by special Teflon system.
- Practical welding fixture changing system



Technical specifications

- Power supply: 400 V, 3ph, 50-60 Hz
- Power output: 4.0 kW
- Max. welding length: 3,400 mm
- Min. welding length: 425 mm
- Max. profile width: 120 mm (for 90° welding)
- Max. profile height: 120 mm
- Air pressure: 6-8 bar
- Air consumption: 100 l/min.



Description

- Strongly welds two corners of PVC profiles with single operation.
- PLC control system
- Double-hand system (2 NCM - S)
- Fixed left head allows welding at variable angles between 30° - 180°.
- Press First starting at 2 bar then up to 6 Bar (2 NCM - S)
- Welds both colored and white profiles with 0,2 mm. welding seam restriction.
- Manually movable right head welds 90°.
- Movable head is moved to the desired position manually and fixed by pneumatic brakes.
- All operations are controlled by the digital touchscreen display.
- Long lasting heating plates distribute heat homogenously.
- Ability to clean the heater plates easily.
- Long lasting Teflon usage and easy change by special Teflon system.
- Practical welding fixture changing system



Technical specifications

- Power supply: 400 V, 3ph, 50-60 Hz
- Power output: 4.0 kW
- Max. welding length: 3,400 mm
- Min. welding length: 425 mm
- Max. profile width: 120 mm (for 90° welding)
- Max. profile height: 120 mm
- Max. profile width: 140 mm (for 90° welding) (2 NCM - S)
- Max. profile height: 160 mm (2 NCM - S)
- Air pressure: 6-8 bar
- Air consumption: 100 l/min.

V Type



29



Description

- V Type Welds transom profile to frame profile.
- Welding angle is fixed at 90°.
- Welds white profiles
- All operations can be controlled automatically.
- Heating and waiting time can be adjusted digitally.



Technical specifications

- Power supply: 230 V, 50-60 Hz
- Power output: 1.5 kW
- Max. Profile Width: 100 mm
- Max. Profile Height: 130 mm
- Air pressure: 6-8 bar
- Air consumption: 20 l/min.
- Machine Height: 1,450 mm
- Machine Length: 920 mm
- Machine Width: 710 mm
- Machine Weight: 295 kg

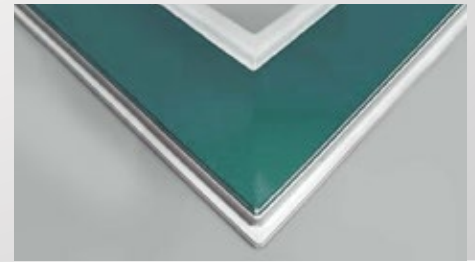

General Specifications

The machine performs automatically the positioning of the heads at the welding sizes and then the cycles for the melting, welding and cooling. At the end of the last cycle the welded frame is conveyed towards the cleaning area.



Standart Specification

- Used to weld four corners of PVC profiles at 90° at the same time
- 10.4" touch screen panel
- CNC control system (3 axes)
- Possibility for 0.2 mm welding for all profile types
- Automatic mould opening system makes the welding seams thinner at separating point
- Easy change mould system
- Resistance teflon wrapping system
- Central lubrication system
- Barcode scanner system sets the welding position without any size entering
- Shift processing capacity: 240 – 250 frames / 8 hours
- Particular care has been taken over the safety measures, both mechanical and electrical
- Barcode system

FEATURES	⚡		🌀		📦	📦		📏				📏				📏
	3 ph 10Kw 30A 50/60 Hz 380V AC	Bar	Air consumption (lt/min)	Kg	H (mm)	W (mm)	D (mm)	h min (mm)	h max (mm)	a min (mm)	a max (mm)	A max (mm)	A min (mm)	B max (mm)	B min (mm)	A°
METRIC		6	200 - 250	2200	1500	3900	5200	40	180	-	120	3500	400	2500	400	90

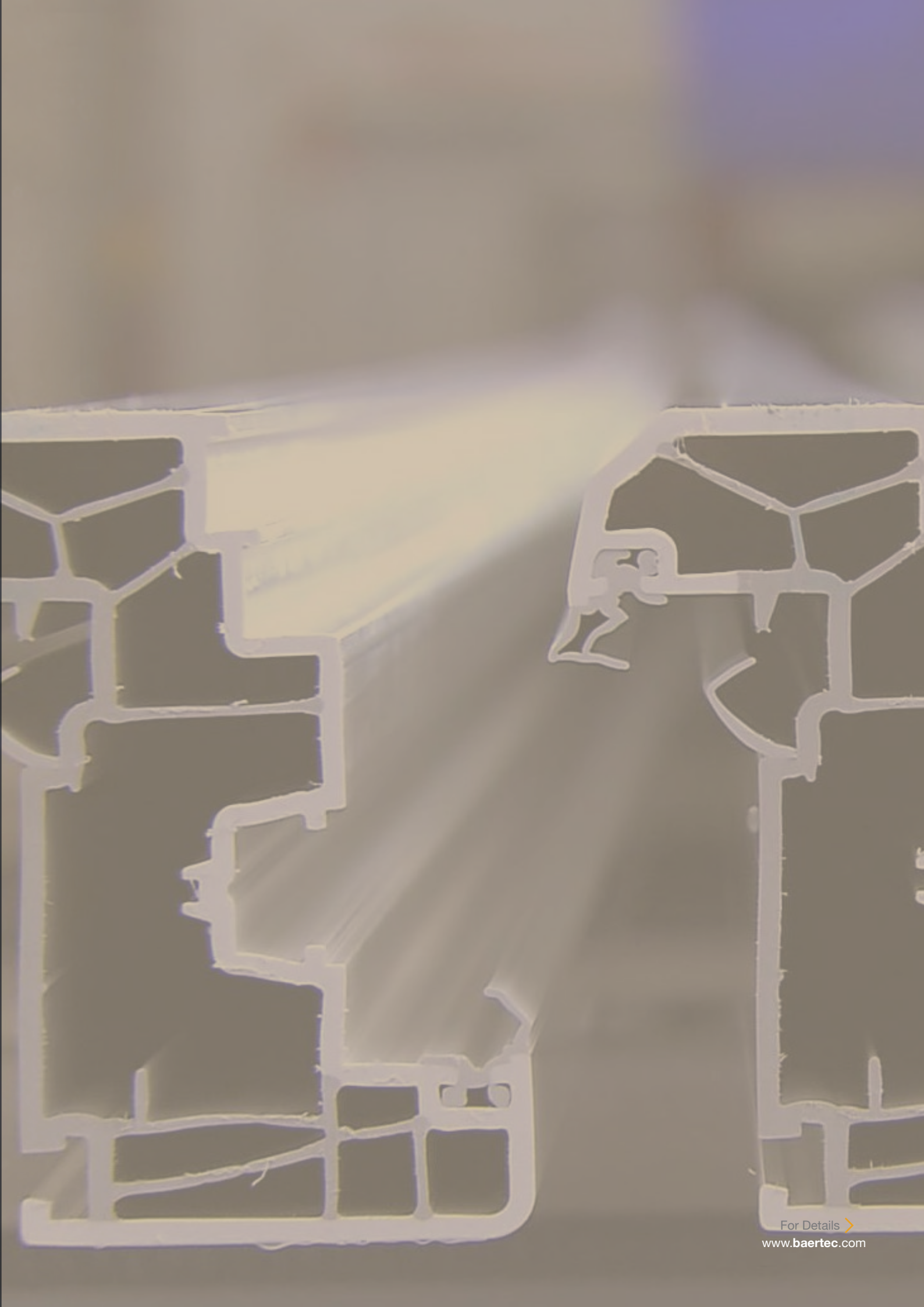

A close-up photograph of a metal router bit mounted on a machine. The bit is positioned vertically, and the machine's body is visible in the background. A circular graphic overlay is centered on the bit, containing the text "ROUTER AND DRILLS" in a bold, sans-serif font. The image has a warm, golden-brown color cast.

**ROUTER
AND
DRILLS**

- 34 **2FRP001** / Portable Copy Router
- 35 **2FR001** / Heavy Duty Copy Router
- 36 **2FR002** / Triple Drilling & Copy Milling Machine
- 37 **2FR003** / Triple Drilling & Copy Milling & Water Drainages Machine
- 38 **2FR003-S Triple** / Drilling Copy Milling & Water Drainages Machine (Hertz Motor)



Description

- 220V single-phase, 27000 r.p.m. brush motor
- Used for aluminium and PVC profiles
- To open lock, hinge and espagnolette slots onto profiles
- Incl. 1 router bit, 1 copy template and material support set

2 FR 001

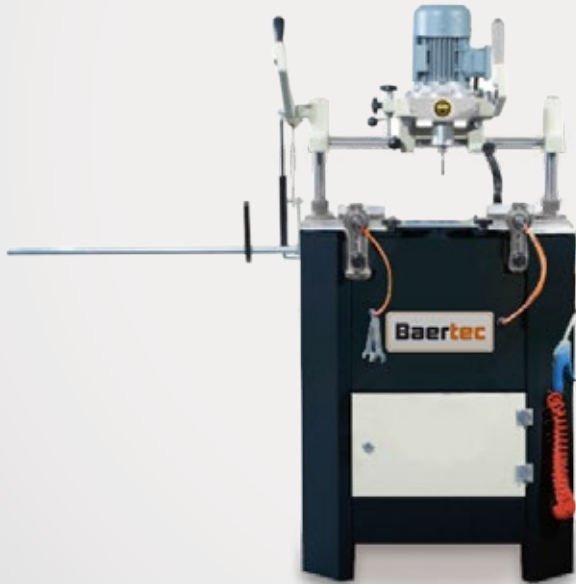

35



Description

- Routing of door handle holes, lock cylinders and drain slots on PVC and aluminum profiles.
- Precise routing with minimal effort and simple operation.
- 1:1 ratio transfer of the pattern from a template onto the profile.
- Frequency controlled (inverter) high speed motor.
- Manual two stepped copy finger for 5 mm. and 8 mm. cutter diameters
- Possibility of template free depth adjustment and routing on two axis with measurement scale rod.
- 2 pcs Pneumatic profile clamping.



Optional

- Cooling system for aluminum profiles.
- Left and right length stop system



Technical specifications

- Power supply: 230 V, 50-60 Hz
- Power output: 0.75 kW
- Spindle speed: 12,000 r.p.m.
- Routing capacity: 250 x 100 mm.
- Air pressure 6-8 bar
- Air consumption: 5 l/min.
- Machine height 1630 mm
- Machine length 460 mm
- Machine width 610 mm
- Machine weight 75 kg



Description

- Designed to open the place for handles, espanyoled calals on PVC profiles
- Clamps devices and angled drain slot routing is equipped with pneumatic system operation
- Centering system by the copy -follow stick
- Three fold drilling unit moves automatic
- Start-up or a stop of the engine of copy system by easy pressing button on the handle
- 3 spindle router for locks, hinks, door handles
- Manual two stepped copy finger for 6 mm. and 8 mm. cutter diameters.
- Triple spindle drilling of PVC sash profiles with reinforcement steel by manual feed



Optional

- Left and right length stop system.



Technical specifications

- Power supply: 400 V, 3ph, 50-60 Hz
- Total power output: 2 kW
- Power output router: 0.75 kW
- Power output triple drill: 1.1 kW
- Router spindle speed: 12,000 r.p.m.
- Drill spindle speed: 930 r.p.m.
- Routing capacity: 250 x 100 mm.
- Stroke: 100 mm.
- Max. profile section dimensions: 110 mm x 100 mm.
- Air pressure: 6-8 bar
- Air consumption: 5 l/min.

2 FR 003



Description

- Routing of door handle holes, lock cylinders and drain slots on PVC profiles.
- Precise routing with minimal effort and simple operation.
- Triple spindle drilling with manual feed for espagnolette holes on PVC sash profiles.
- Drain slot milling at varying angles.
- Frequency controlled (inverter) high speed motor.
- Manual two stepped copy finger for 6 mm. and 8 mm. cutter diameters.
- Possibility of template free depth adjustment and routing on two axis with measurement scale rod.
- Pneumatic profile clamping.



Optional

- Left and right length stop system



Technical specifications

- Power supply: 400 V, 3ph, 50-60 Hz
- Total power output: 2.22 kW
- Power output milling: 0.75 kW
- Power output triple drill: 1.1 kW
- Power output router: 0.37 kW
- Router spindle speed: 12,000 r.p.m.
- Drill spindle speed: 930 r.p.m.
- Routing capacity: 250 x 100 mm.
- Stroke: 100 mm.
- Max. profile section dimensions: 110 mm x 100 mm.
- Air pressure: 6-8 bar

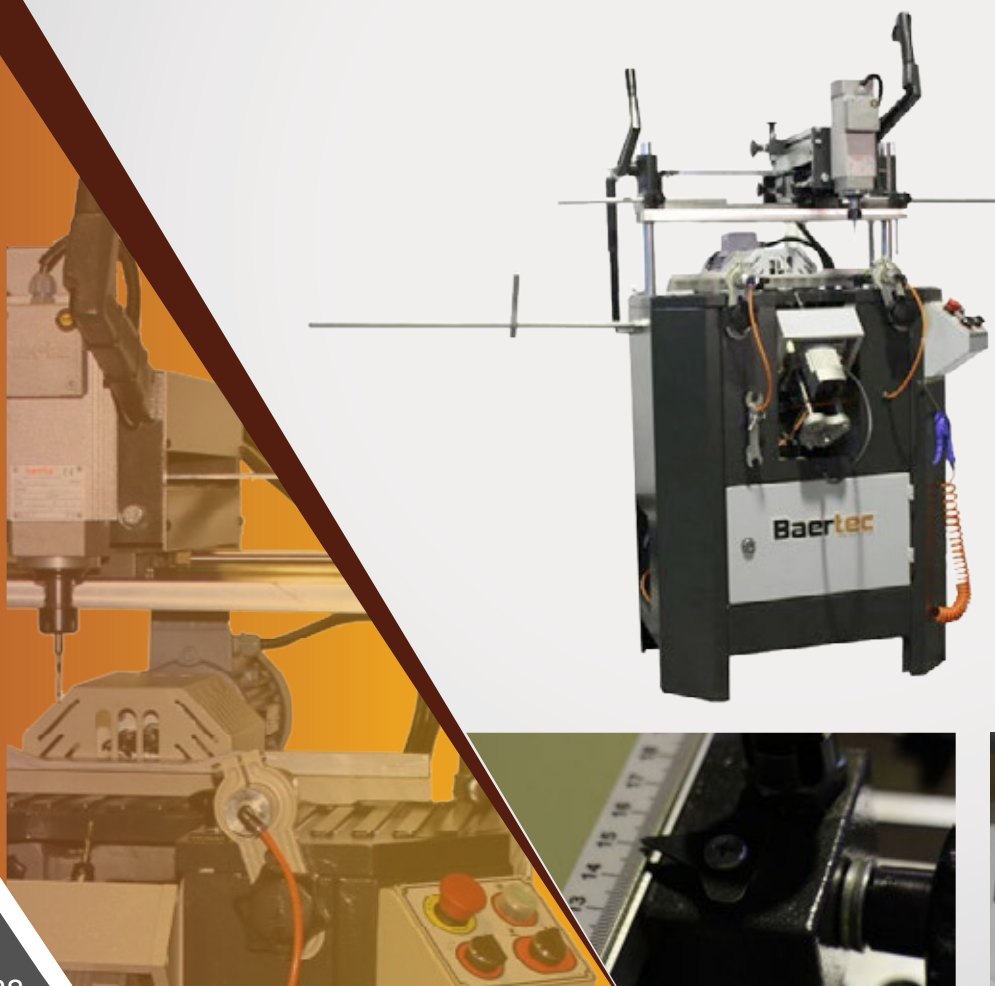

Description

- Routing of door handle holes, lock cylinders and drain slots on PVC profiles.
- Precise routing with minimal effort and simple operation.
- Triple spindle drilling with manual feed for espagnolette holes on PVC sash profiles.
- Drain slot milling at varying angles.
- Frequency controlled (inverter) high speed motor.
- Manual two stepped copy finger for 6 mm. and 8 mm. cutter diameters.
- Possibility of template free depth adjustment and routing on two axis with measurement scale rod.
- Pneumatic profile clamping.



Optional

- Left and right length stop system



Technical specifications

- Power supply: 400 V, 3ph, 50-60 Hz
- Total power output: 2.22 kW
- Power output milling: 0,55 kW
- Power output triple drill: 1.1 kW
- Power output router: 1,50 kW
- Router spindle speed: 12,000 r.p.m.
- Drill spindle speed: 930 r.p.m.
- Routing capacity: 250 x 100 mm.
- Stroke: 100 mm.
- Max. profile section dimensions: 110 mm x 100 mm.
- Air pressure: 6-8 bar



**CORNER
CLEANING
MACHINES**

- 42 **2KT 002** / PVC Corner Cleaning Machine 2 Cutter Group
- 43 **2KT 004** / PVC Corner Cleaning Machine 4 Cutter Group
- 44 **2KT 004-S** / Pvc Corner Cleaning Machine 4 Cutter Group (Special)
- 45 **2KT 008** / Pvc Corner Cleaning Machine 8 cutter Group
- 46 **4KTCNC2** / CNC Corner Cleaning Machine



Description

- Cleans the welding seam on lower, upper surfaces of welded profiles with grooving knives.
- Mills the welding seam at the outer corners of welded profiles with two different set of disk cutters.
- Full automatic PLC operating system.
- Automatic identification and cutter set positioning for frame and sash profiles.
- Four different cutter sets can be settled.- All operations are controlled by the digital touchscreen display.
- Automatic system for pushing the welded profiles to the back fence to provide accurate centering.
- The profiles are fixed by horizontal clamps to ensure optimum work piece fixing.
- Standard equipped with profile support arms.
- This model 2 cutter group



Technical specifications

- Power supply: 400 V, 3ph, 50-60 Hz
- Power output: 1.1 kW
- Spindle speed: 2,800 r.p.m.
- Max. cutter diameter: 160 mm.
- Max. Profile Width: 120 mm
- Max. Profile Height 90 mm
- Min. Profile Height 40 mm
- Air pressure: 6-8 bar

2 KT 004



43



Description

- Cleans the welding seam on lower, upper surfaces of welded profiles with grooving knives.
- Mills the welding seam at the outer corners of welded profiles with two different set of disk cutters.
- Full automatic PLC operating system.
- Automatic identification and cutter set positioning for frame and sash profiles.
- Four different cutter sets can be settled.- All operations are controlled by the digital display.
- Automatic system for pushing the welded profiles to the back fence to provide accurate centering.
- The profiles are fixed by horizontal clamps to ensure optimum work piece fixing.
- Standard equipped with profile support arms.
- This model 4 cutter group



Technical specifications

- Power supply: 400 V, 3ph, 50-60 Hz
- Power output: 1.1 kW
- Spindle speed: 2,800 r.p.m.
- Max. cutter diameter: 160 mm.
- Max. Profile Width: 120 mm
- Max. Profile Height 90 mm
- Min. Profile Height 40 mm



Description

- Cleans the welding seam on lower, upper surfaces of welded profiles with grooving knives.
- Mills the welding seam at the outer corners of welded profiles with two different set of disk cutters.
- Full automatic PLC operating system.
- Automatic identification and cutter set positioning for frame and sash profiles.
- Four different cutter sets can be settled.- All operations are controlled by the digital touchscreen display.
- Automatic system for pushing the welded profiles to the back fence to provide accurate centering.
- The profiles are fixed by horizontal clamps to ensure optimum work piece fixing.
- Standard equipped with profile support arms.
- This model 4 cutter group
- Lock system



Technical specifications

- Power supply: 400 V, 3ph, 50-60 Hz
- Power output: 1.1 kW
- Spindle speed: 2,800 r.p.m.
- Max. cutter diameter: 160 mm.
- Max. Profile Width: 120 mm
- Max. Profile Height 170 mm
- Min. Profile Height 30 mm

2 KT 008



45



Description

- Mills the welding seam at the outer corners of welded profiles with two different set of disk cutters.
- Full automatic PLC operating system.
- Automatic identification and cutter set positioning for frame and sash profiles.
- Four different cutter sets can be settled.- All operations are controlled by the digital display.
- Automatic system for pushing the welded profiles to the back fence to provide accurate centering.
- The profiles are fixed by horizontal clamps to ensure optimum work piece fixing.
- Standard equipped with profile support arms.
- This model 8 cutter group.



Technical specifications

- Power supply: 400 V, 3ph, 50-60 Hz
- Power output: 1.1 kW
- Spindle speed: 2,800 r.p.m.
- Max. cutter diameter: 160 mm.
- Max. Profile Width: 120 mm
- Max. Profile Height 90 mm
- Min. Profile Height 40 mm
- Air pressure: 6-8 bar



Standart Specification

- Used to clean the welded corners of PVC windows
- CNC control system (2 axis)
- Corner cleaning time 15-25 sec. depending on profile type
- Movable 8.4" touch screen panel
- Easy system for profile setup and programming
- High cleaning performance with tools operated by servo control
- High and standard quality in each profile surface with 9 cleaning tools
- Up & bottom gasket hole drills
- Up & bottom inner corner cleaning system (special patented design)
- Up & bottom color – white surface cleaning blade system
- Separate blades for white and laminated profiles
- Adjustment of operating speeds to the desired speeds
- Wide stand with brushes provides easy operation and protects profile surface from scratches
- 500 profile memory capacity
- Multi language support
- Shift processing capacity: 190 – 200 items / 8 hours

9 Tools :

- 1 - top gasket cleaner
- 2 - top colored profile surface cleaner
- 3 - top white profile surface cleaner
- 4 - top inner corner cleaner
- 5 - bottom gasket cleaner
- 6 - bottom colored profile surface cleaner
- 7 - bottom white profile surface cleaner
- 8 - bottom inner corner cleaner
- 9 - outer corner cleaning saw

METRIC	V		A	Bar	Air consumption	Kg	H (mm)	W (mm)	D (mm)	Ø D (mm)	Ø d (mm)	w (mm)	A min (mm)	B min (mm)	a max (mm)	a min (mm)	b max (mm)
		380	3	8	8 - 10	105 l/min.	450	1850	900	1470	250	30	3	350	350	120	30





**END
MILLING
MACHINES**

- 50 **2OMP001** / Portable End Milling Machine
- 51 **2OM 001** / Semi Automatic End Milling Machine Single Series
- 52 **2OO001** / End Milling Machine Single Cutter Series
- 53 **2OO002** / End Milling Machine Double Cutter Series



Description

- For end milling of transom in PVC and Aluminum profiles.
- Automatic feed of the milling unit.
- Ability to route at varying angles up to 45° left and 30° right.
- Vertical pneumatic profile clamping system enables optimum work piece fixing.
- Positioning of the tools with pneumatic feed cylinder.
- Without changing the cutter set, two different series of transom profiles can be processed.
- Right and Left move Manual



Optional

- Cooling system for aluminum profiles.
- Hydro-pneumatic feed system to route aluminum profiles



Technical specifications

- Power supply: 400 V, 3ph, 50-60 Hz
- Power output: 1,1 kW
- Max. cutter diameter: 160 mm.
- Spindle speed: 3,000 r.p.m.
- Max. routing height: 90 mm.
- Max. routing depth: 30 mm.
- Max. profile width: 120 mm.
- Max. profile height: 90 mm.
- Air pressure: 6-8 bar

2 OM 001



51



Description

- For end milling of transom in PVC and Aluminum profiles.
- Automatic feed of the milling unit.
- Ability to route at varying angles up to 45° left and 30° right.
- Vertical pneumatic profile clamping system enables optimum work piece fixing.
- Positioning of the tools with pneumatic feed cylinder.
- Without changing the cutter set, two different series of transom profiles can be processed.
- Right and Left move Manual



Optional

- Cooling system for aluminum profiles.
- Hydro-pneumatic feed system to route aluminum profiles



Technical specifications

- Power supply: 400 V, 3ph, 50-60 Hz
- Power output: 1,1 kW
- Max. cutter diameter: 160 mm.
- Spindle speed: 3,000 r.p.m.
- Max. routing height: 90 mm.
- Max. routing depth: 30 mm.
- Max. profile width: 120 mm.
- Max. profile height: 90 mm.
- Air pressure: 6-8 bar



Description

- For end milling of transom in PVC and Aluminum profiles.
- Automatic feed of the milling unit.
- Ability to route at varying angles up to 45° left and 30° right.
- Vertical pneumatic profile clamping system enables optimum work piece fixing.
- Positioning of the tools with pneumatic feed cylinder.
- Without changing the cutter set, two different series of transom profiles can be processed.



Optional

- Cooling system for aluminum profiles.
- Hydro-pneumatic feed system to route aluminum profiles



Technical specifications

- Power supply: 400 V, 3ph, 50-60 Hz
- Power output: 1,1 kW
- Max. cutter diameter: 160 mm.
- Spindle speed: 3,000 r.p.m.
- Max. routing height: 90 mm.
- Max. routing depth: 30 mm.
- Max. profile width: 120 mm.
- Max. profile height: 90 mm.
- Air pressure: 6-8 bar

End Milling Machine Double Cutter Series

2 00 002



53



Description

- For end milling of transom in PVC and Aluminum profiles.
- Automatic feed of the milling unit.
- Ability to route at varying angles up to 45° left and 30° right.
- Vertical pneumatic profile clamping system enables optimum work piece fixing.
- Positioning of the tools with pneumatic feed cylinder.
- Without changing the cutter set, two different series of transom profiles can be processed.



Optional

- Cooling system for aluminum profiles.
- Hydro-pneumatic feed system to route aluminum profiles.



Technical specifications

- Power supply: 400 V, 3ph, 50-60 Hz
- Power output: 1,1 kW
- Max. cutter diameter: 160 mm.
- Spindle speed: 3,000 r.p.m.
- Max. routing height: 90 mm.
- Max. routing depth: 30 mm.
- Max. profile width: 120 mm.
- Max. profile height: 90 mm.
- Air pressure: 6-8 bar



**CORNER
CRIMPING
MACHINE**

Baertec

Aluminium Corner Crimping Machine

CORNER
CRIMPING
MACHINE

2 AP



55



Description

- Joins the corners of aluminum profiles by crimping the corner of the profile into the wedge.
- Hydraulic operating system sustains high pressure power.
- Hydraulic clamps enable maximum profile fixation.
- Ability to work with all types of profiles.
- The crimping blades can be adjusted easily with magnetic fixation system.
- The support is lowered hydraulically for easy loading and off-loading of work pieces.
- Step by step control of the operation by means of foot pedal.



Technical specifications

- Power supply: 400 V, 3 ph, 50-60 Hz
- Power output: 3.0 kW
- Hydraulic pressure: 180 bar
- Pressing Power: 8,000 kgf
- Min. profile height: 15 mm.
- Max. profile height: 90 mm.
- Max. profile width: 140 mm.
- Machine Height: 1,250 mm
- Machine Length: 1,000 mm
- Machine Width 800 mm
- Machine Weight 350 kg

SCREWDRIVER MACHINE



Baertec

SCRW 01



57



Description

- For single profile processing.
- Automatic screwing of the reinforcement profile by means of foot pedal switch.
- Adjustable according to different profile cross sections.
- Pneumatic clamping during processing.
- Automatic screw feed.
- Automatic depth stop system independent from profile height.
- Standard equipped with profile support conveyors left and right.



Technical specifications

- Max. profile section dimensions: 110 mm x 80 mm.
- Min. profile width: 40 mm Air pressure: 6-8 bar
- Air consumption: 200 l/min.
- Machine height: 2,150 mm
- Machine length: 400 mm (3,910 mm. incl. conveyors)
- Machine width: 750 mm
- Machine weight: 115 kg

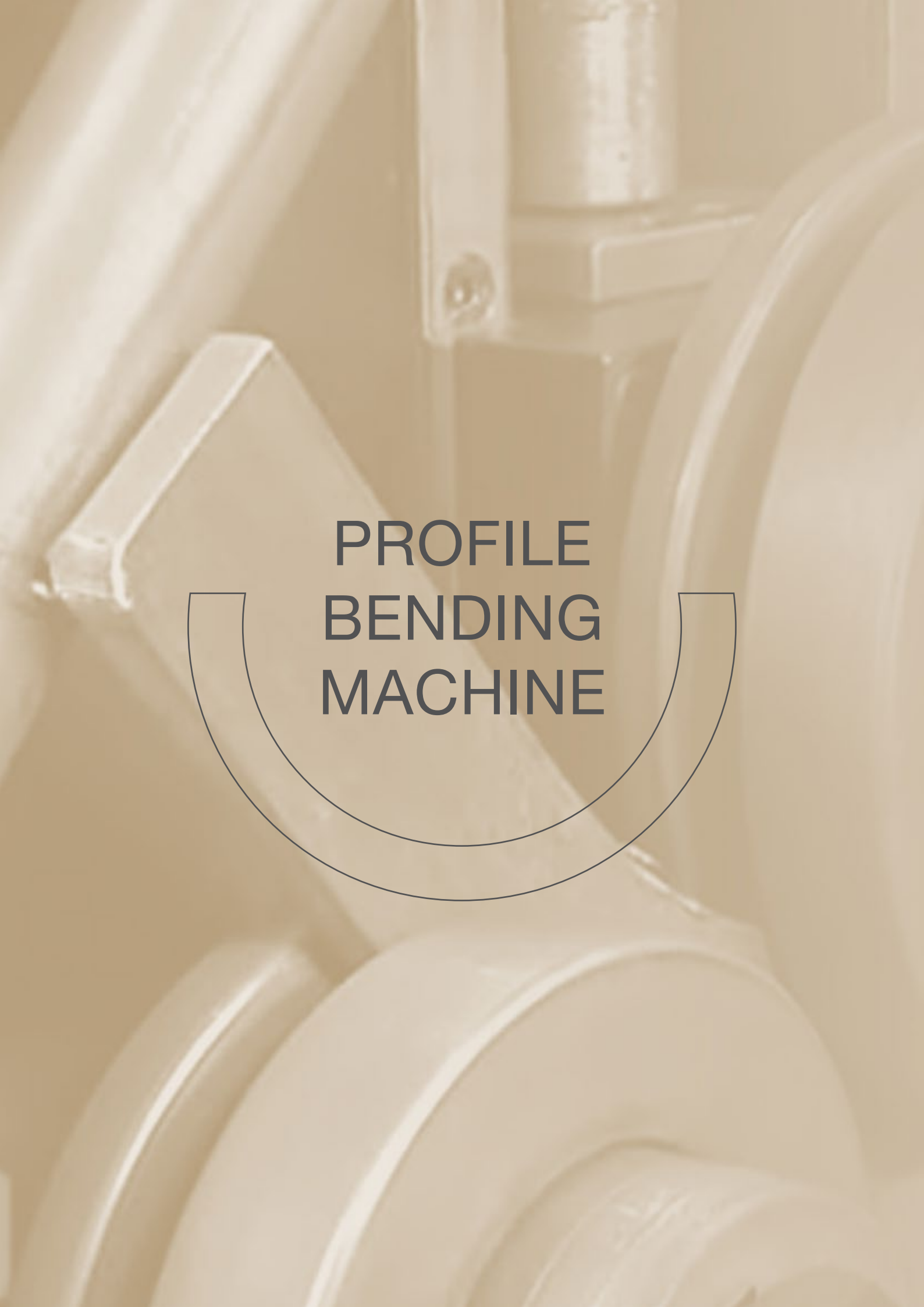

**PROFILE
BENDING
MACHINE**

- 58 **BBP 28** Portable Motorised Profile And Section Bending Machine 28'
- 59 **BB 28** Motorised Profile And Section Bending Machine 28'
- 60 **BB 30** Motorised Profile And Section Bending Machine
- 61 **BB 35** Motorised Profile And Section Bending Machine
- 62 **BB 40** Motorised Profile And Section Bending Machine 40'
- 63 **BHB 40** Hydraulic Profile And Section Bending Machines 40'
- 64 **BHB 50** Hydraulic Profile And Section Bending Machines 50'



Description

- Aluminium profiles and pipes bending
- Two rolls are driven
- Standart rolls are 3 pieces.
- Working in horizontal and vertical
- Minimum bending diameter is 450 mm
- Upper body is portable



Technical specifications

- Power supply: 400 V, 3 ph, 50-60 Hz
- Power output: 0,55 Kw
- Top Roll Diameter: Ø 180 mm
- Lower Rolls Diameter : Ø 118 mm
- Shaft Diameters:Ø 28
- Machine Height: 1,450 mm
- Machine Length: 600 mm
- Machine Width 580 mm
- Machine Weight 75 kg

BB 28



61

General Specifications

Ideal for making flanges, greenhouses, balausters, tables, chairs, doors, windows....., making a great number of circular shape in all kinds of profiles.



Standart Specification

- Steel frame
- Minimum bending diameter is 450 mm
- Reducer driven gear system
- Top roll idle
- Top roll up and down movement by hand
- Bottom rolls fixed and powered
- Rolls and shafts are made DELRIN
- Rolls and shafts are hardened and grinded
- Able to bend flat bars and box sections with standard rolls
- Standard rolls are interchangeable to adjust gap for bending
- Standard guide rolls
- Able to work both horizontal and vertical position
- Users manual book in English or Turkish
- CE certificate



Optional

- Bending apparatus
- Angled side armrest



Additional Accessories

- Pipe bending rolls for different sizes
- Angle bending rolls (leg in and led out)
- Aluminium bending rolls made of SAE 1050 quality steel
- Angle guide rolls
- C-S Bending attachment for wrought iron
- Bar twisting attachment for wrought iron



Technical specifications

- Power supply: 400 V, 3 ph, 50-60 Hz
- Power output: 0,55 Kw
- Top Roll Diameter: Ø 180 mm
- Lower Rolls Diameter : Ø 118 mm
- Shaft Diameters:Ø 28
- Machine Height: 1,450 mm
- Machine Length: 600 mm
- Machine Width 580 mm
- Machine Weight 75 kg



General Specifications

Ideal for making flanges, greenhouses, balausters, tables, chairs, doors, windows...., making a great number of circular shape in all kinds of profiles.



Standart Specification

- Steel frame
- Reducer driven gear system
- Top roll idle
- Top roll up and down movement by hand
- Bottom rolls fixed and powered
- Rolls and shafts are made of SAE 1050 quality steel
- Rolls and shafts are hardened and grinded
- Able to bend flat bars and box sections with standard rolls
- Standard rolls are interchangeable to adjust gap for bending
- Standard guide rolls
- Able to work both horizontal and vertical position
- Users manual book in English or Turkish
- CE certificate



Optional

- Bending apparatus
- Angled side armrest



Additional Accessories

- Pipe bending rolls for different sizes
- Angle bending rolls (leg in and led out)
- Aluminium bending rolls made of DELRIN
- Angle guide rolls
- C-S Bending attachment for wrought iron
- Bar twisting attachment for wrought iron



Technical specifications

- Power supply: 400 V, 3 ph, 50-60 Hz
- Power output: 0,75 Kw
- Top Roll Diameter: Ø 148 mm
- Lower Rolls Diameter : Ø 118 mm
- Shaft Diameters: Ø 30 mm
- Machine Height: 1,450 mm
- Machine Length: 800 mm
- Machine Width 600 mm
- Machine Weight 250 kg

BB 35



63



Standart Specification

- Steel frame
- Two rolls direct driven by a gear system
- Rolls are hardened
- Rolls shafts are special steel material hardened and ground
- Roll shafts housed by bearings
- Standard rolls
- Guide rolls
- Horizontal and vertical working position



Technical specifications

- Power supply: 400 V, 3 ph, 50-60 Hz
- Power output: 1,5 Kw
- Top Roll Diameter: Ø 155 mm
- Lower Rolls Diameter : Ø 118 mm
- Shaft Diameters:Ø 50 mm
- Machine Height: 1,450 mm
- Machine Length: 800 mm
- Machine Width 1000 mm
- Machine Weight 400 kg



General Specifications

Ideal for making flanges, greenhouses, balausters, tables, chairs, doors, windows...., making a great number of circular shape in all kinds of profiles.



Standart Specification

- Steel frame
- Reducer driven gear system
- Top roll idle
- Top roll up and down movement by hand
- Bottom rolls fixed and powered
- Rolls and shafts are made of SAE 1050 quality steel
- Rolls and shafts are hardened and grinded
- Able to bend flat bars and box sections with standard rolls
- Standard rolls are interchangeable to adjust gap for bending
- Standard guide rolls
- Able to work both horizontal and vertical position
- Users manual book in English or Turkish
- CE certificate



Optional

- Bending apparatus
- Angled side armrest



Additional Accessories

- Pipe bending rolls for different sizes
- Angle bending rolls (leg in and led out)
- Aluminium bending rolls made of DELRIN
- Angle guide rolls
- C-S Bending attachment for wrought iron
- Bar twisting attachment for wrought iron



Technical specifications

- Power supply: 400 V, 3 ph, 50-60 Hz
- Power output: 0,75 Kw
- Top Roll Diameter: Ø 148 mm
- Lower Rolls Diameter : Ø 118 mm
- Shaft Diameters: Ø 40 mm
- Machine Height: 1,450 mm
- Machine Length: 800 mm
- Machine Width 600 mm
- Machine Weight 250 kg

Hydraulic Profile and Section Bending Machine 40'

PIPE
BENDING
MACHINES

BHB 40



65



Standart Specification

- Stable cast steel frame
- 3 Rolls motor driven
- Hardened and polished rolls
- Horizontal and vertical working position
- Standart roll-set
- Controlled by foot-pedal
- Two digital read-outs
- Control panel



Technical specifications

- Power supply: 400 V, 3 ph, 50-60 Hz
- Power output: 1,1 Kw
- Top Roll Diameter: Ø 137 mm
- Lower Rolls Diameter : Ø 118 mm
- Shaft Diameters:Ø 40
- Machine Height: 1,250 mm
- Machine Length: 1050 mm
- Machine Width 500 mm
- Machine Weight 350 kg



Standart Specification

- Steel Frame
- Reducer driven gear system
- Top roll idle
- Top roll up and down movement hdraulic
- Bottom rolls fixed and powered
- Rolls and shafts are made of SAE 1050 qaulity steel
- All rolls and shafts are hardened and grinded
- Able to bend flat bars and box sections with standart roll
- Standart rolls are interchangeable to adjust gap for bending
- Standart guide rolls
- Able to work both horizontal and vertical position
- User manuel book in English



Technical specifications

- Shaft Diameters : Ø 50 mm
- Lower Rolls Dimaeter : Ø 162 mm
- Top Rolls Dimaeter : Ø 152 mm
- Hydraulic Power:16 Ton
- Workin Speed:4 m/min
- Power:1,12 kW
- Lenght:800 mm
- Widht:650 mm
- Height:1500 mm
- Weight:550 kg



Optional

- Pipe bending rolls for different sizes
- Angle bending rolls (leg in and leg out)
- Aluminium bending rolls made of DELRIN
- Digital read out for top roll
- Angle guide rolls
- Speed variator

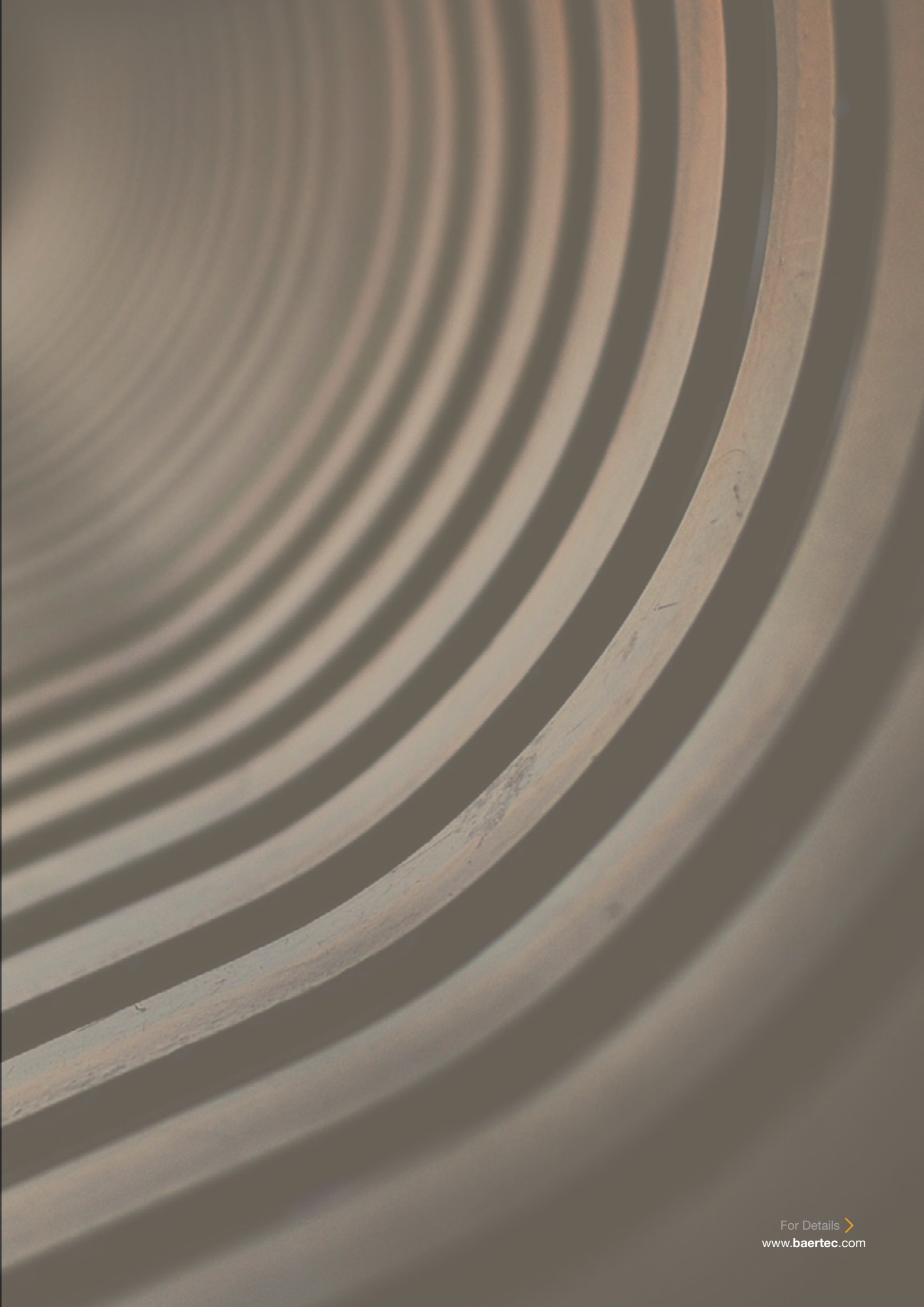



**METAL
SAWING
MACHINES**

- 68 **T275 | T315** / Metal Sawing Machine(Manual)
- 69 **T275P | T315P** / 2.Speed Circular saw (Manual with Pneumatic Vice)
- 70 **T275V | T315V** / 2.Speed Circular saw(Manual with V Vice)
- 71 **T275VP | T315VP** / 2.Speed Circular saw (Manual with Pneumatic V Vice)
- 72 **T275Y | T315Y** / 2.Speed Circular saw (Semi Automatic with Hydro-check)
- 73 **TTM350** / Circular Saw (Manual)



Technical specifications

- 2 Speed main motor
- Adjustable bar stop to make cuts of the same length
- 45 right to 45 left cutting
- Double head return spring
- Coolant tank with box to collect chips and electric pump for blade lubrication and cooling
- Gearbox reduction in oil bath with adjustable bearings



Technical specifications (T 315)

- 2 Speed main motor
- Adjustable bar stop to make cuts of the same length
- 45 right to 45 left cutting
- Double head return spring
- Coolant tank with box to collect chips and electric pump for blade lubrication and cooling
- Gearbox reduction in oil bath with adjustable bearings

	W=600 H=1400 L=1100					
	210	3~	102	1,3- 1,8	45/90	120

					D 315
	105	85	120x70		d 32
	90	80	90x60		i 10
					f 63

2 Speed Circular Saw (Manual With Pneumatic Vice)

T 275 P
T 315 P



Technical specifications

- 2 Speed main motor
- Adjustable bar stop to make cuts of the same length
- 45 right to 45 left cutting
- Double head return spring
- Coolant tank with box to collect chips and electric pump for blade lubrication and cooling
- Gearbox reduction in oil bath with adjustable bearings



Technical specifications (T 315 P)

- 2 Speed main motor
- Adjustable bar stop to make cuts of the same length
- 45 right to 45 left cutting
- Double head return spring
- Coolant tank with box to collect chips and electric pump for blade lubrication and cooling
- Gearbox reduction in oil bath with adjustable bearings

	W=600 H=1400 L=1100					
	210	3~	10.2	1,3-1,8	45/90	120

					D 315
	105	85	120x70		d 32
	90	80	90x60		i 10
					f 63



Technical specifications

- 2 Speed main motor
- Adjustable bar stop to make cuts of the same length
- 45 right to 45 left cutting
- Double head return spring
- Coolant tank with box to collect chips and electric pump for blade lubrication and cooling
- Gearbox reduction in oil bath with adjustable bearings



Technical specifications (T 315 V)

- 2 Speed main motor
- Adjustable bar stop to make cuts of the same length
- 45 right to 45 left cutting
- Double head return spring
- Coolant tank with box to collect chips and electric pump for blade lubrication and cooling
- Gearbox reduction in oil bath with adjustable bearings

	W=600 H=1400 L=1100					
	185	3~	102	1-1,3	45/90	120

			D 275
			d 32
			i 10
			f 63

2 Speed Circular Saw (Manual With Pneumatic V Vice)

T 275 VP
T 315 VP

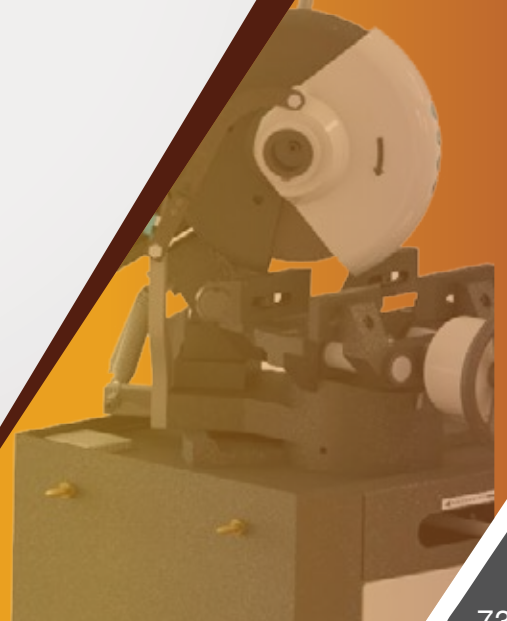

73



Technical specifications

- 2 Speed main motor
- Adjustable bar stop to make cuts of the same length
- 45 right to 45 left cutting
- Double head return spring
- Coolant tank with box to collect chips and electric pump for blade lubrication and cooling
- Gearbox reduction in oil bath with adjustable bearings



Technical specifications (T 315 P)

- 2 Speed main motor
- Adjustable bar stop to make cuts of the same length
- 45 right to 45 left cutting
- Double head return spring
- Coolant tank with box to collect chips and electric pump for blade lubrication and cooling
- Gearbox reduction in oil bath with adjustable bearings

		W=600 H=1400 L=1100 Kg 210					

					D 315
	105	85	120x70		d 32
	90	80	90x60		i 10
					f 63



Technical specifications

- 2 Speed main motor
- Adjustable bar stop to make cuts of the same length
- 45 right to 45 left cutting
- Double head return spring
- Coolant tank with box to collect chips and electric pump for blade lubrication and cooling
- Gearbox reduction in oil bath with adjustable bearings



Technical specifications (T 315 Y)

- 2 Speed main motor
- Adjustable bar stop to make cuts of the same length
- 45 right to 45 left cutting
- Double head return spring
- Coolant tank with box to collect chips and electric pump for blade lubrication and cooling
- Gearbox reduction in oil bath with adjustable bearings
- Hydro-pneumatic control system

	W=600 H=1400 L=1100 Kg 210					
		3~	102	1,3- 1,8	45/90	120

					D 315
					d 32
					i 10
					f 63

TTM 350



75



Standart Specification

- Stationary cutting machine with cutting disc for solid materials and profiles
- Solid and forceful construction
- Easy to operate
- Turnable saw head 45 degree to left and right
- Control handle with safety switch
- Emergency stop button
- Safety regulations according to CE standartd



Technical specifications

- Power supply: 400 V, 50 Hz , 5kw
- Cut off wheel diameter : 350 mm
- Cutting range round : 100 mm
- Cutting range at 90 degree square : 100 x 100 mm
- Vice Open : 100 mm
- Cutting range at 90 degree rectangular:120 x 90 mm
- Revolution Speed: 5400 min/
- Machine height: 1,700 mm
- Machine length: 970 mm
- Machine width: 620 mm
- Machine weight: 230 kg

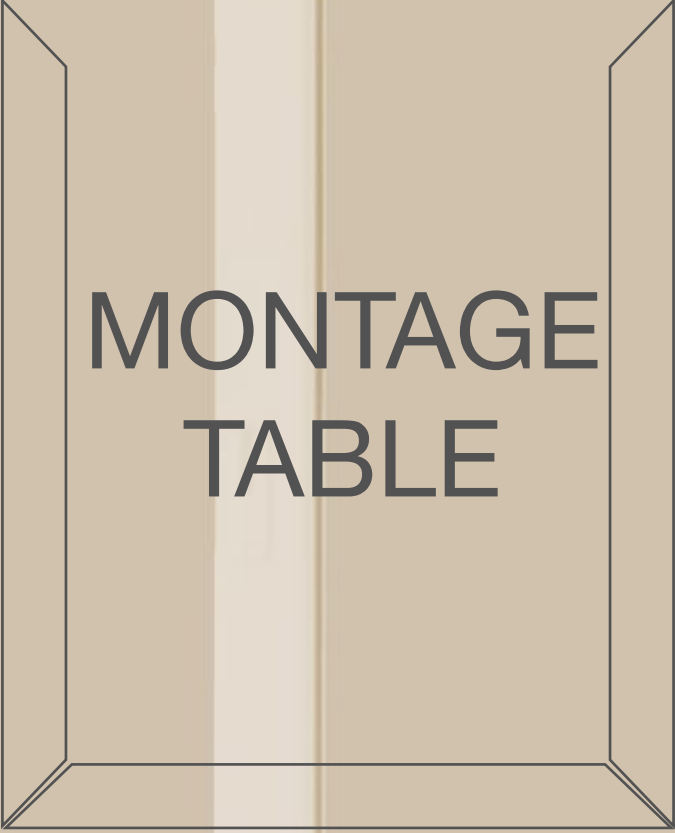

**MONTAGE
TABLE**

BA 3000

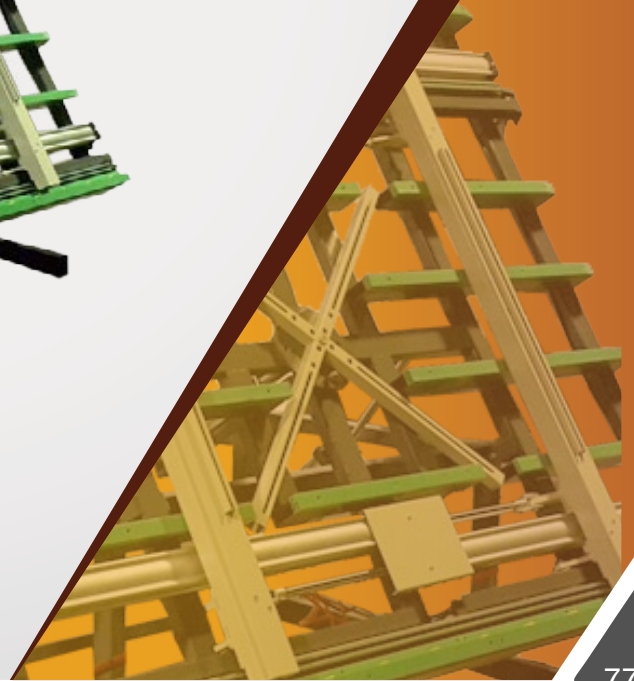

77



Description

Assembly table for vertical and horizontal assembly

- Stable steel construction
- Important when switching from vertical to horizontal transportation and vice versa
- Ideal for vertical and horizontal assembly
- Pneumatic tilting
- Supporting surfaces with plastic slide bars
- Roller support can be lowered pneumatically
- Fast installation of Glass on the windows and doors
- Glazed joinery transferring to package on rollers



Technical specifications

- Length 3,000 mm
- Width 2,420 mm
- Vertical height 2,52 mm
- Roller conveyor width 210 mm
- Weight 370 kg
- Load 190 kg
- Compressed air supply 6 bar
- Air consumption approx. 39 l/min.

DUST EXTRACTION

ACCESSORIES



Baertec

Dust Extractor

DUST
EXTRACTION



General Specifications

The BAE 2000 from Scheppach is a must have for professional workshops. The BAE 2000 connects to almost any woodworking and Upvc Aluminium machines to extract any dust, wood and pvc & Alu chips and other mess that is emitted to ensure your work area and the air around you is kept clean and free from pollution. The BAE 2000 features long 2.5 metre hose, 100mm hose connector suitable for use with a range of power tools and machinery and 135 litre collection bag.



Technical specifications

- 2000 m³/h Air Flow Capacity
- 135 Litre Collection Bag Capacity
- 2.5 metre Hose - Hose Connection Diameter: 100mm
- Low Pressure: 2500 Pa
- Noise Level: 82dB(A)
- Dimensions (L x W x H): 1090mm x 580mm x 2090mm - Weight: 40kg

ACCESSORIES

Conveyor Profile Running Unit

2 BKR 2
2 BKR 3



79



CNC ALUMINIUM PROFILE MACHINING AND CUTTING CENTER

81

HSM-ALU 3000 - CNC CONTROLLED PROFILE MACHINING CENTER (3+1 AXIS)

82

HSM-ALU 6000 - CNC CONTROLLED PROFILE MACHINING CENTER (4 AXIS)

83

HSM-ALU 9000 - CNC CONTROLLED PROFILE MACHINING AN CUTTING CENTER (10 AXIS)

Baertec

CNC CONTROLLED PROFILE MACHINING CENTER

3+1 AXIS

HSM-ALU 3000



81



Standart Specification

- Processing tools (5 pieces)
- Ability to process 2 profiles in parallel (except inner surfaces)
- Cabinet providing protection in processing zone



Optional

- Barcode reader
- Automatic lubrication
- Optional length on X-axis
- Ability to perform processing in two separate zones (6000)
- Side tunnels



Technical specifications

- Used for performing milling, drain channel opening, drilling, marking and milling processes on aluminum and PVC profiles.
- Non-standard specific operations on different profile. CNC based control system. Precise process at any angle between -90° and $+90^{\circ}$. Automatic tool replacement. Automatic magazine for 8 tools. Automatic clamping positioning. Industrial PC with Windows based touchscreen and easy to use practical interface. Remote access. Data transfer over remote network connection, Ethernet and USB. High processing capacity to increase efficiency. Ability to process profiles over 3000 mm with double gauge system. Automatic lubrication in processing area.



Standart Specification

- Processing tools (5 pieces)
- Ability to process 2 profiles in parallel (except inner surfaces)
- Cabinet providing protection in processing zone



Optional

- Barcode reader
- Automatic lubrication
- Optional length on X-axis
- Ability to perform processing in two separate zones (6000)
- Side tunnels



Technical specifications

- Used for performing milling, drain channel opening, drilling, marking and milling processes on aluminum and PVC profiles.
- Non-standard specific operations on different profile. CNC based control system. Precise process at any angle between -90° and $+90^{\circ}$. Automatic tool replacement. Automatic magazine for 8 tools. Automatic clamping positioning. Industrial PC with Windows based touchscreen and easy to use practical interface. Remote access. Data transfer over remote network connection, Ethernet and USB. High processing capacity to increase efficiency. Ability to process profiles over 3000 mm with double gauge system. Automatic lubrication in processing area.

CNC CONTROLLED PROFILE MACHINING AND CUTTING CENTER

10 AXIS

HSM-ALU 9000



83



Standard Specification

- Ø 550 mm saw blade
- Automatic waste discharge unit
- Barcode printer



Optional

- Compatibility with CAM programs



Technical specifications

- Used for cutting, milling, punching and marking processes on 4 surfaces of profiles.
- Servo controlled cutting. Servo controlled rotation axis. Automatic positioning at all degrees between 30° and 150° with servo motion system. Pneumatic holder robot with servo axis control and manual adjustment feature for accurate positioning of profiles. Industrial PC with Windows based touchscreen and easy to use practical interface. Remote access Data transfer over remote network connection, Ethernet and USB. Guard cabin for cutting and machining area. Adjustable saw blade travel speed. Discharge unit with pneumatic conveying system. Resume feature (emergency stops, blackouts, etc.) provides cutting advice by making a full scan in cutting list and detecting uncut pieces. Feeding capacity for 7 profiles High cutting capacity to increase efficiency. High speed axis movements. Automatic lubrication in processing area. Ability to process 4 different surfaces of a profile. Ability to use cutting and processing units independently.

Baertec

| **BAERTEC** |
PVC Aluminium Processing Machinery

 Factory
Minareliçavuş Mh. Şeftali Cd. Dökümcüler San. Sit.
106 Sk. No: 22-24-26 / 16140 Nilüfer - Bursa / Turkey

 + 90 224 483 4 826
 + 90 224 351 0 500
 info@baertec.com